



BATTERY  
MONITORING

# **EZSELECT™** **Lite**

**EZSELECT™ LITE BATTERY  
SELECTION SYSTEM**



# OWNER'S MANUAL

# CONTENTS

<b>Introduction</b> .....	3
<b>System Components</b>	
Individual Components .....	4
Spare Parts .....	5
<b>Planning / Specifying Job</b>	
Installation Overview .....	6
Tools Required .....	6
Power Availability .....	6
Control Box .....	7
Charger Monitoring Devices (CMD) .....	7
Data Cable Requirements .....	7
Installation & Commissioning Service .....	7
Pre-Installation Checklist .....	7
<b>Installation</b>	
Installation Overview .....	8
Control Box and CMD Installation .....	9
Installation Checklist .....	10
<b>Operation</b>	
Selecting the Next Available Battery .....	11
System Feedback .....	11
CMD Visual LED Indications .....	11
Operation Overview .....	12

# INTRODUCTION

## **EZSELECT™** **Lite**

The EZSelect™ Lite battery selection system optimises battery room performance by simplifying battery selection during the battery change procedure.

A fully installed system includes a Charger Monitoring Device (CMD) mounted on each charger. The CMD monitors charger behaviour and communicates with the Control Box. The Control Box prioritises the data to ensure the optimal battery is positioned first in the queue.

The EZSelect™ Lite battery selection system displays the next battery to select with a bright blue LED indication on a CMD. If the wrong battery is chosen, an audible alarm is activated. This ensures that all batteries and chargers are cycled uniformly, thereby maximising their service life.

**For service, contact your sales representative or call:**

**EnerSys EMEA**  
EH Europe GmbH  
Baarerstrasse 18  
6300 Zug, Switzerland  
Tel: +41 44 215 74 10

**EnerSys World Headquarters**  
2366 Bernville Road  
Reading, PA 19605, USA  
Tel: +1-610-208-1991  
+1-800-538-3627

**EnerSys APAC**  
No. 85, Tuas Avenue 1  
Singapore 639518  
Tel: +65 6558 7333

[www.enersys.com](http://www.enersys.com)

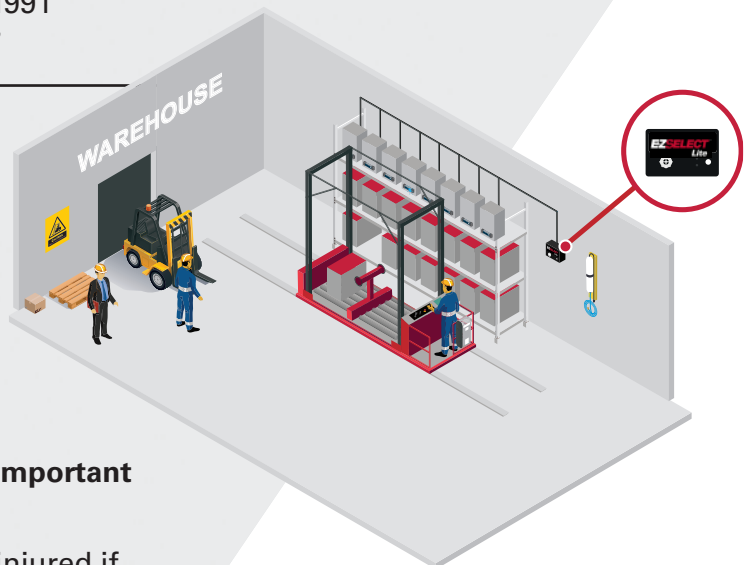

**Your Safety and the Safety of Others is Very Important**

**⚠ WARNING** You can be killed or seriously injured if you don't follow instructions.

# SYSTEM COMPONENTS

## Individual Components

Figure 1: Overview of the EZSelect™ Lite battery selection system components

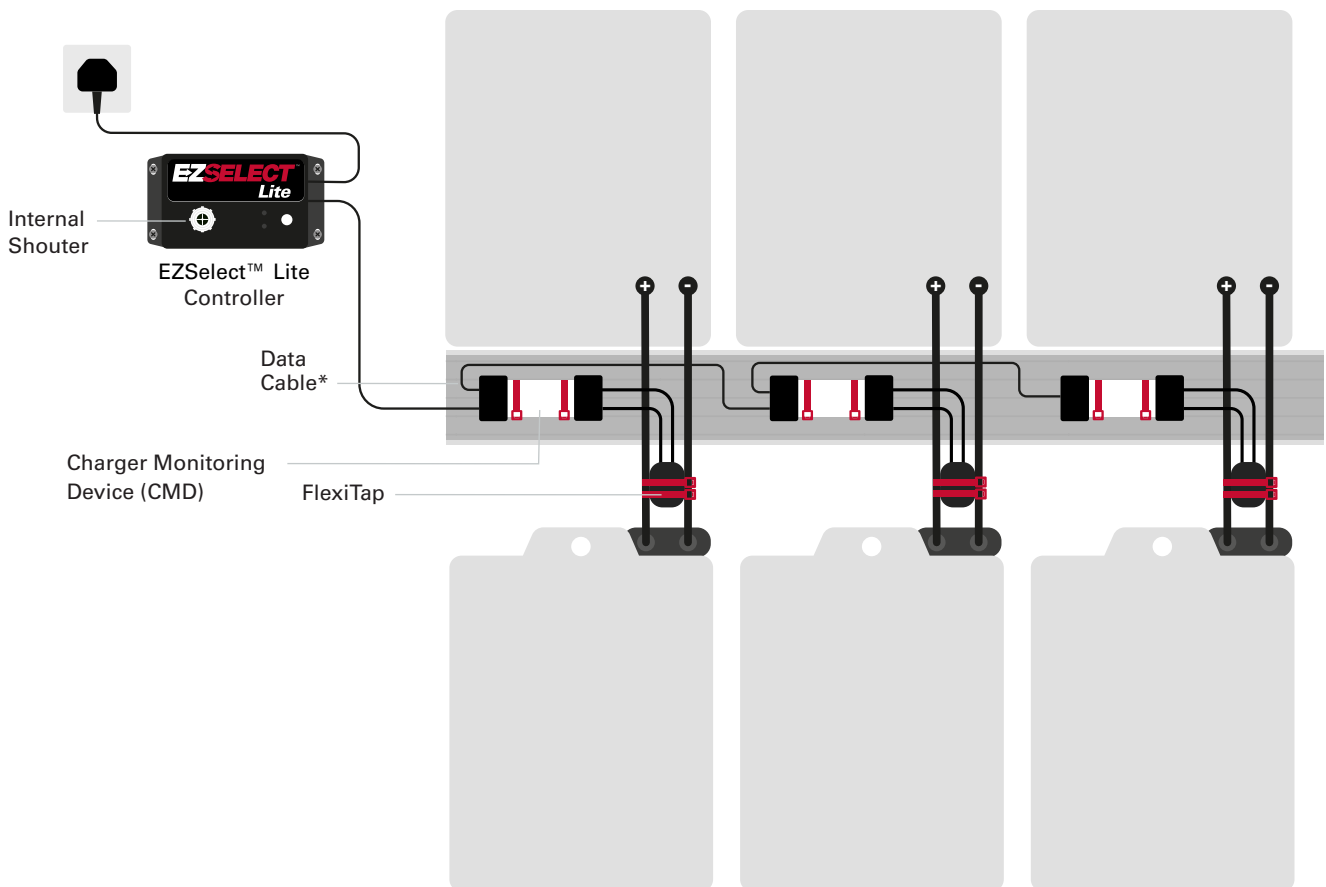

\*Various parts available

# SYSTEM COMPONENTS

## Spare Parts



**EZS-CB6400EU-16**

EZSelect™ Lite Control Box  
(Max 50 chargers in a single pool)



**EZS-143**

8m Data Cable with one Coupler



**EZS-SU600R**

Charger Monitoring Device (CMD)  
(2.1m data cable per CMD included)



**EZS-228**

CMD 2.1m Data Cable

# PLANNING/SPECIFYING JOB

## Installation Overview

On-site installation can be divided into three stages:

1. **Control Box**
  - a. Control Box
2. **CMD Wiring Connections**
  - a. Mount to Chargers
  - b. Wiring from the Control Box to first CMD
  - c. Wiring from CMD to CMD
  - d. Labelling the Chargers/Battery Bays
3. **Final Testing**
  - a. Testing Control Box Operation
  - b. Operator Training

## Tools Required



Drill and Bit



Appropriate Screws  
& Anchors for  
mounting

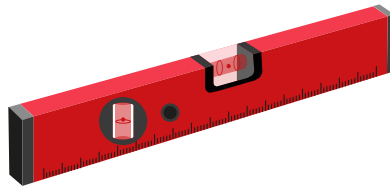

Level



Screwdriver

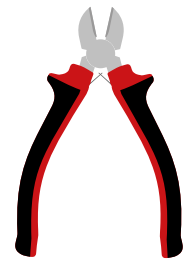

Wire Cutter

## Power Availability

EZSelect™ Lite Battery Selection System Component Power Requirements:

### Control Box

Power supply input: 100-240 VAC 50/60 Hz

### Layout planning instructions to consider

Extension cords can be used temporarily but surge protection is highly recommended for the Control Box.

# PLANNING/SPECIFYING JOB

## Control Box

The Control Box should be located in an adequate clearance around the CMD to connect cables

- Mount in a visible area, free of obstructions.
- Keep the component away from the water sources such as emergency showers and sinks.
- Use appropriate anchors as necessary to support the Control Box.

## Charger Monitoring Devices (CMD)

One CMD is needed per charger. The CMD is universal and can be used for any voltage from 12V to 80V.

## Data Cable Requirements

Data cables connect the Control Box to the CMD. When planning an installation, cable lengths should be kept to a minimum. With every Control Box you should have:

- 2 x 8m cables
- 1 x cable coupler

Example of cabling is shown in Figure 3.

## Installation & Commissioning Services

The EZSelect™ Lite battery selection system is designed to not require commissioning by EnerSys®, but if assistance is required, it is offered by request. Installation videos are also available online.

## Pre-Installation Checklist

Task	Status
<b>A. Plan Location of Control Box</b>	
<ul style="list-style-type: none"><li>• Power for Control Box</li><li>• Near chargers</li><li>• Plan for data cable run to the first CMD in each bus</li></ul>	<input type="checkbox"/>
<b>B. Gather all required tools and equipment</b>	
<ul style="list-style-type: none"><li>• Ladders and/or scissor lifts</li><li>• Power tools - for mounting Control Box, etc.</li><li>• Hand tools - wire cutter, screwdriver</li><li>• Extension cords for temporary power</li><li>• Anchors for mounting components as necessary</li></ul>	<input type="checkbox"/>

# INSTALLATION

## System Overview

Figure 3: Sample layout of the EZSelect™ Lite battery selection system installation

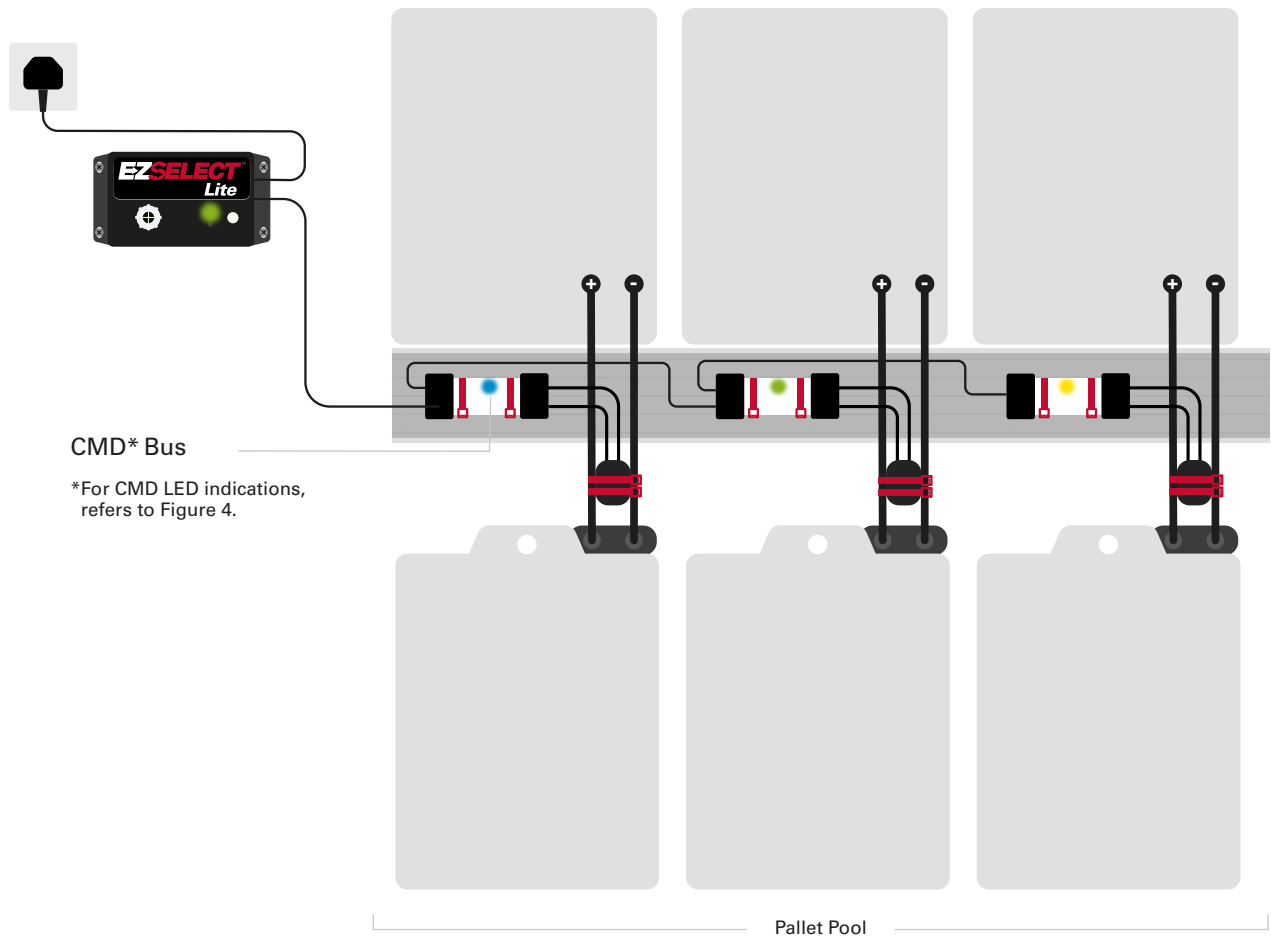

# INSTALLATION

## Control Box & CMD Installation

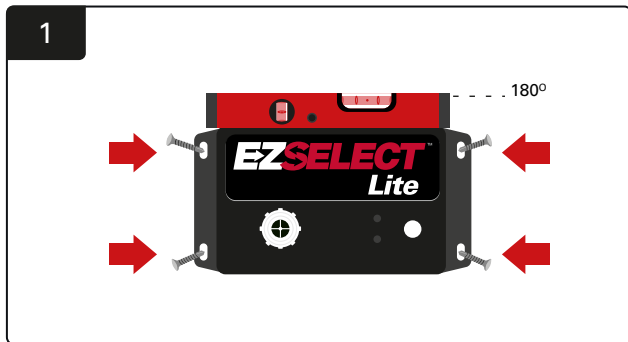

Mount the control box to the wall using four screws/anchors and a level.



Insert the first CMD data cable into one of the available bus sockets on the Control Box.

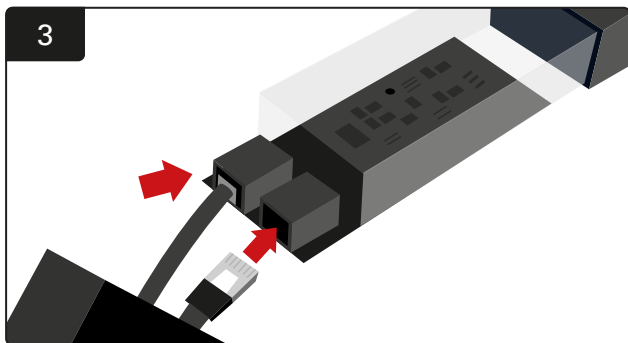

Insert the first CMD data cable into a socket on the first CMD. Connect the next data cable into the other socket.

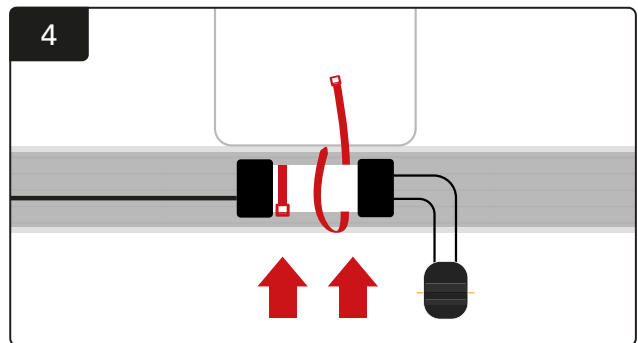

Mount the CMD with cable ties so that it is visible, safe and secure.

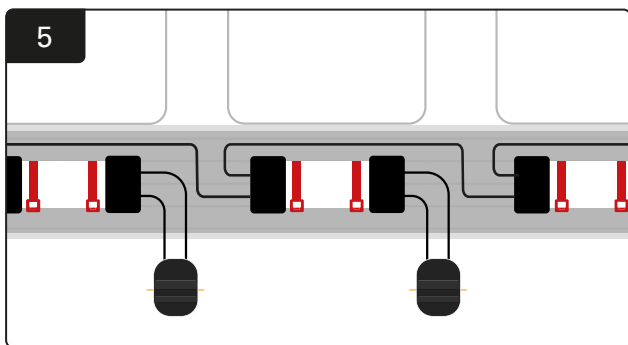

Connect the CMD in series until all the CMDs on bus are connected.  
\*Max 50 CMDs within a single pool.

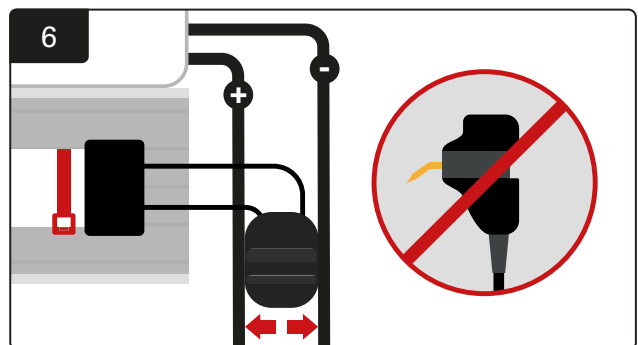

Place the connector in-between the positive and negative cables, and connect the FlexiTaps to the cables respectively.  
\*Ensure the pins are in the centre of the cables and do not bend the pins.

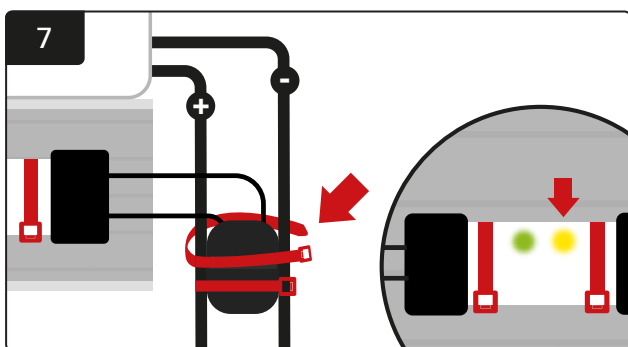

Secure the connector with cable ties. Confirm amber LED illuminates on the CMD with a battery connected.

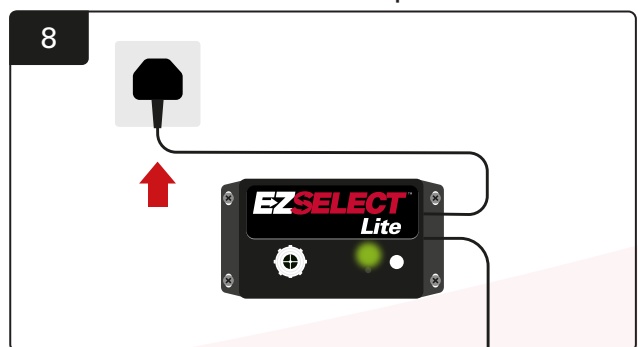

Connect the controller to the power source, and confirm the green LED illuminates.

# INSTALLATION CHECKLIST

Task	Status
1. Make sure all CMDs are displaying a solid green light.	<input type="checkbox"/>
2. Test the Shouter for "Incorrect" battery pick sounds from the Control Box.	<input type="checkbox"/>

## Selecting The Next Available Battery

Keep all batteries plugged in until they are selected unless they are selected for maintenance. The system detects when a battery is connected to the charger, when the charger starts and finishes, and how long the battery is connected to the charger before it is picked.

How to select the next available battery:

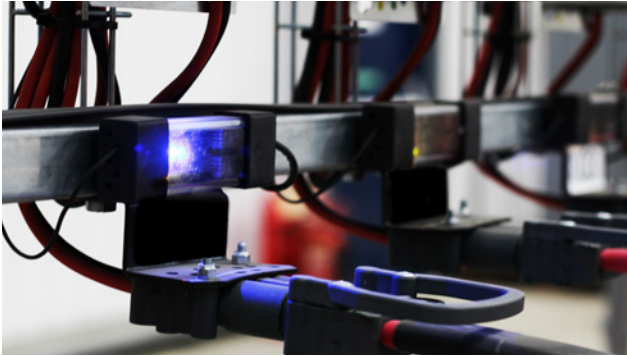

### Charger Monitoring Device (CMD)

Solid blue LED indicates the battery is available to pick.

## System Feedback

The shouter on the Control Box sounds with an alarm when a battery other than the one indicated by the system is selected. When this occurs, the system considers it as a 'mispick'.

## Charger Monitoring Device (CMD) Visual LED Indications

Figure 4: LED Indications for CMD

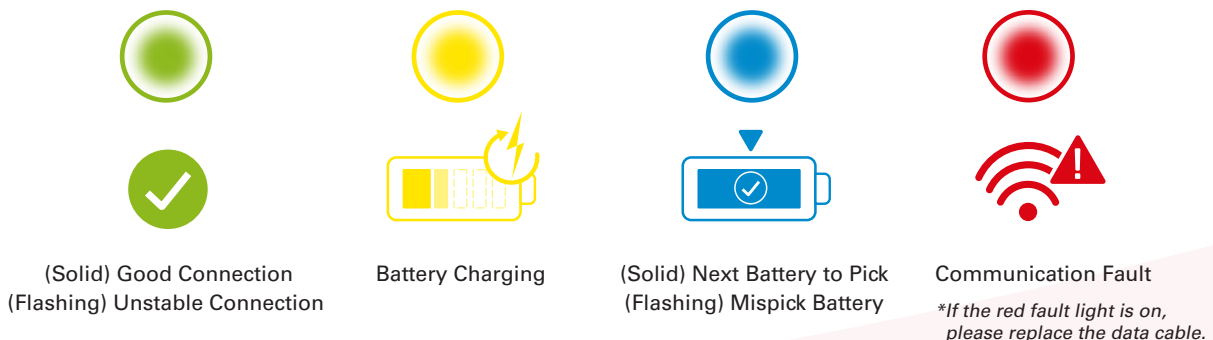

# OPERATION OVERVIEW

Figure 5: Sample layout of the EZSelect™ Lite battery selection system operation

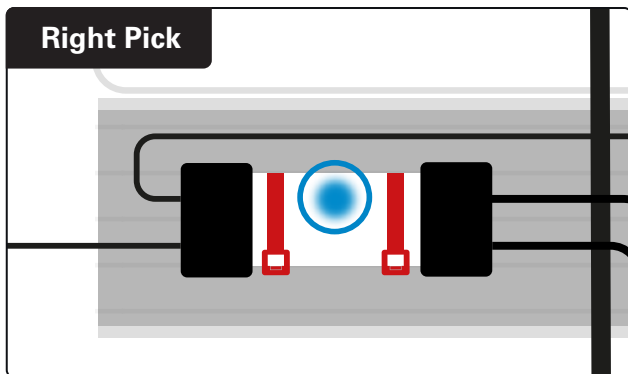
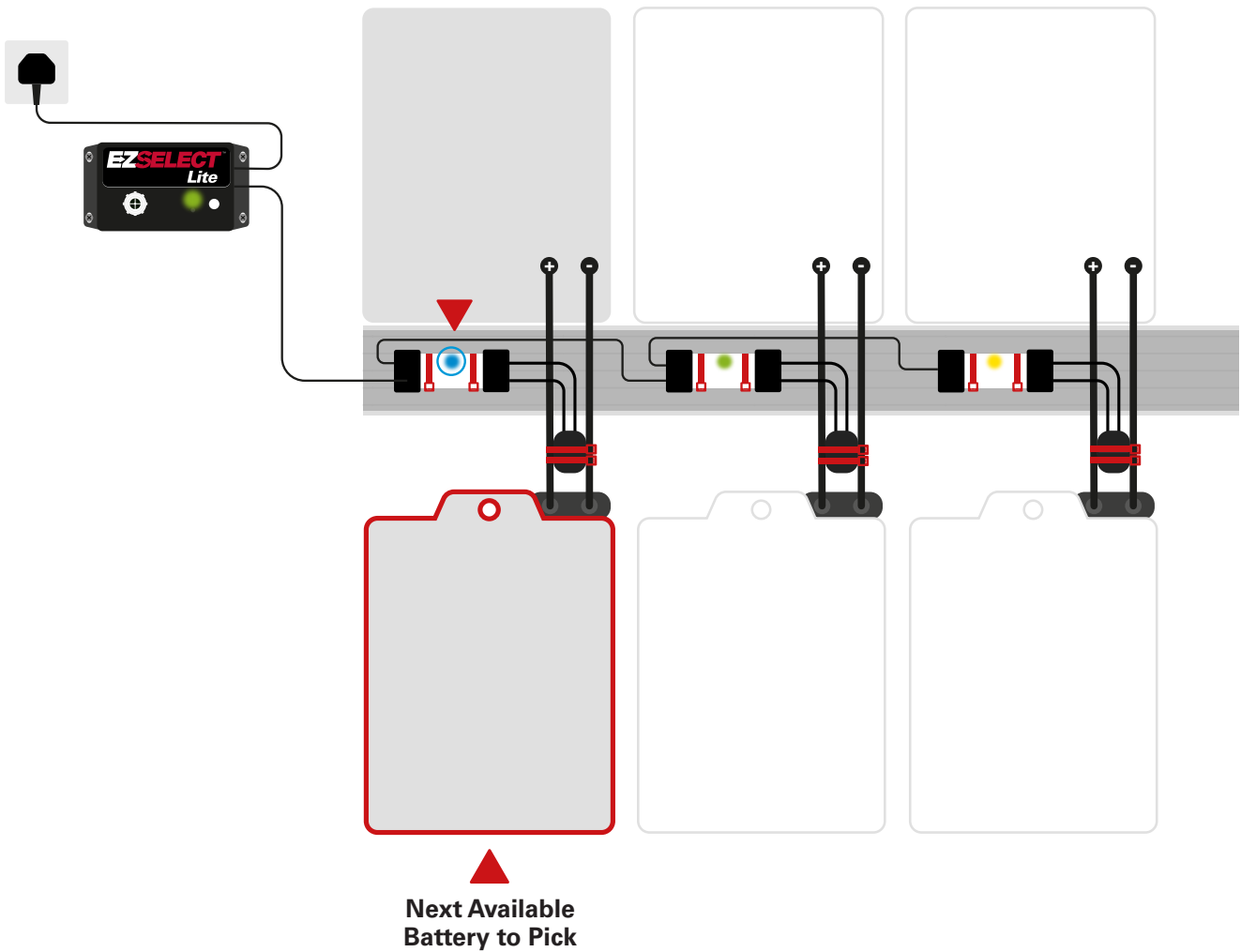

Pick the available battery with the **solid blue LED** illuminates on the CMD.

\*For CMD LED indications, refers to Figure 4.

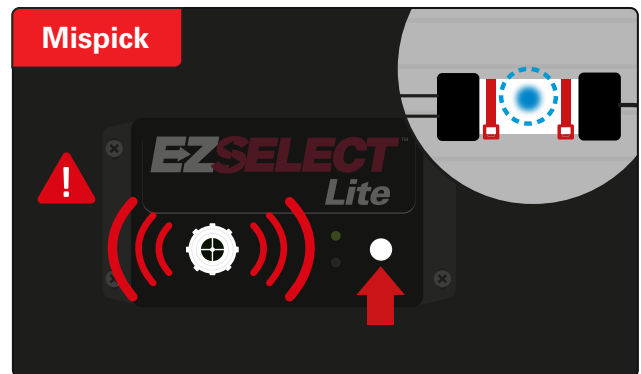

If a battery is selected out of order, the **alarm** will sound from the Control Box shouter to alert the operator.

Press the white button on the controller, and look for the **flashing blue LED** on the CMD to locate which battery is being mispicked.

[www.enersys.com](http://www.enersys.com)

© 2026 EnerSys. All Rights Reserved. All trademarks and logos are the property of EnerSys except Unistrut, CE, and UKCA which is not the property of EnerSys. Subject to revision without prior notice. E&O.E. 160626

GLOBAL-EN-OM-EZSELECT-LITE-0626

